

# DesignCAD 2020 Release Notes

## 1. PDF Underlay

*Available in DesignCAD 3D Max and DesignCAD 2D Express.*

PDF compatibility has been expanded to now include PDF Underlay. Previously, only 2D file export was supported along with the import of 2D Geometry. Please see the example 2D PDF Underlay imported successfully into DesignCAD 2020.

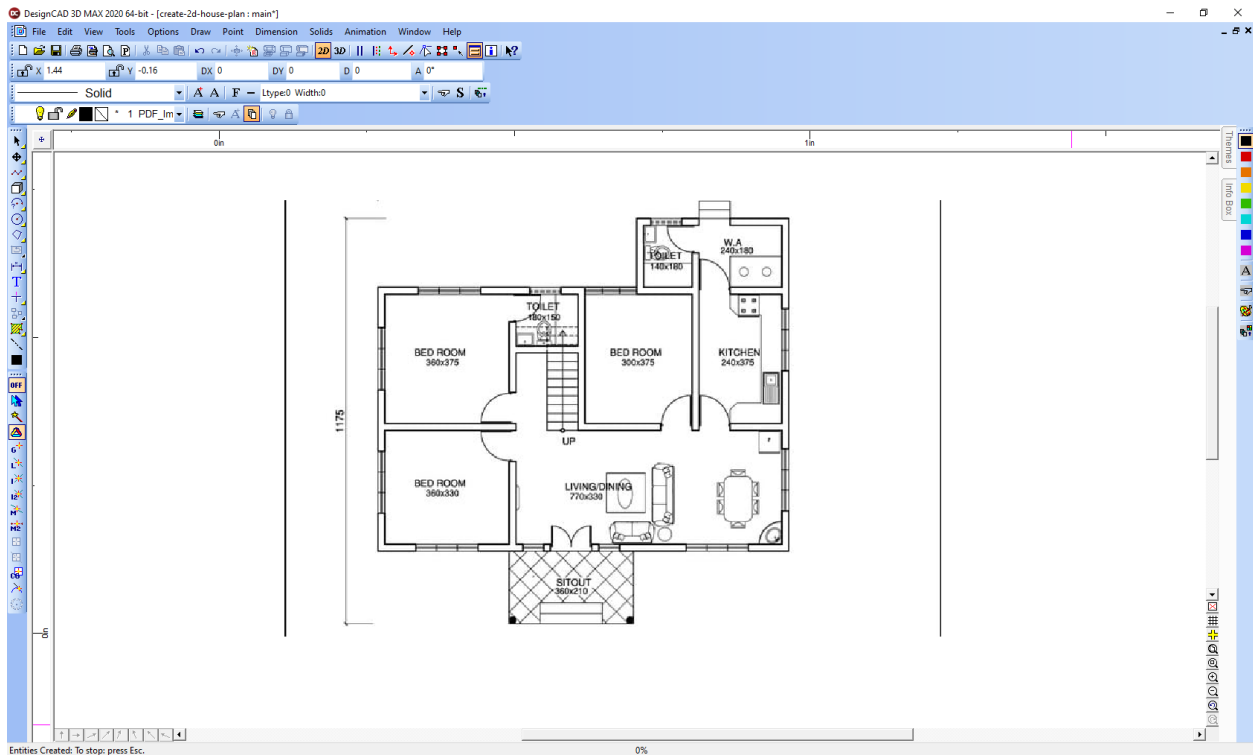

## 2. 2D Adobe Illustrator with option to import as underlay

*Available in DesignCAD 3D Max and DesignCAD 2D Express.*

Adobe illustrator import filter has been added in DesignCAD. User can import the Adobe illustrator file as an underlay or simply its geometry.

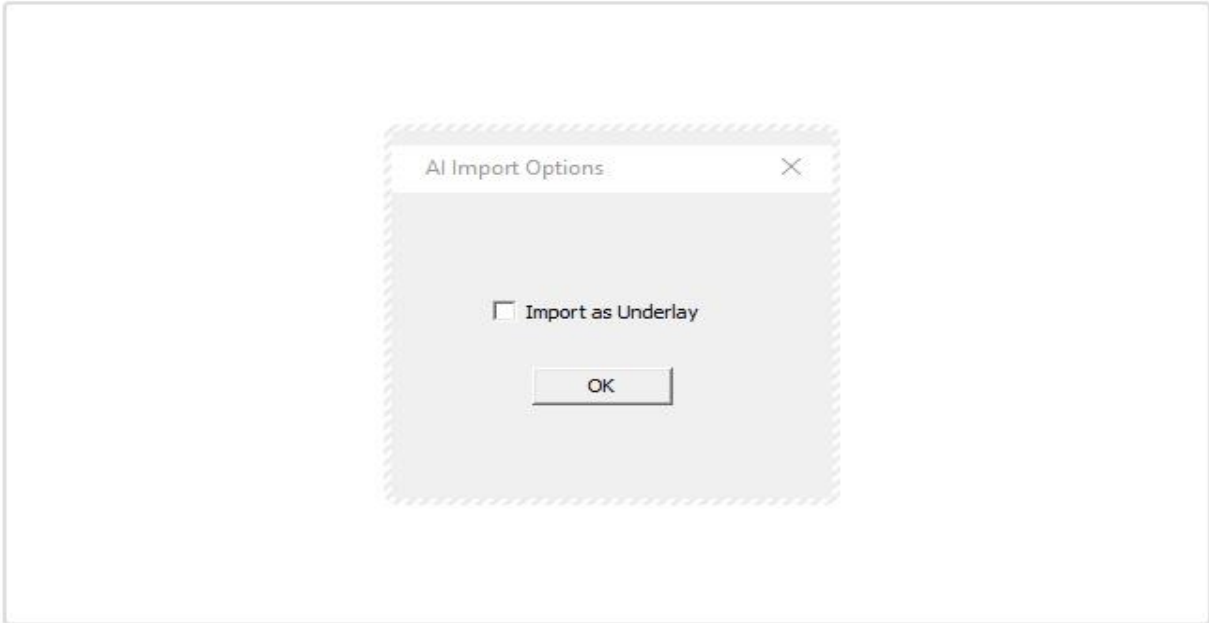

Below is an example of Adobe illustrator file imported in DesignCAD.

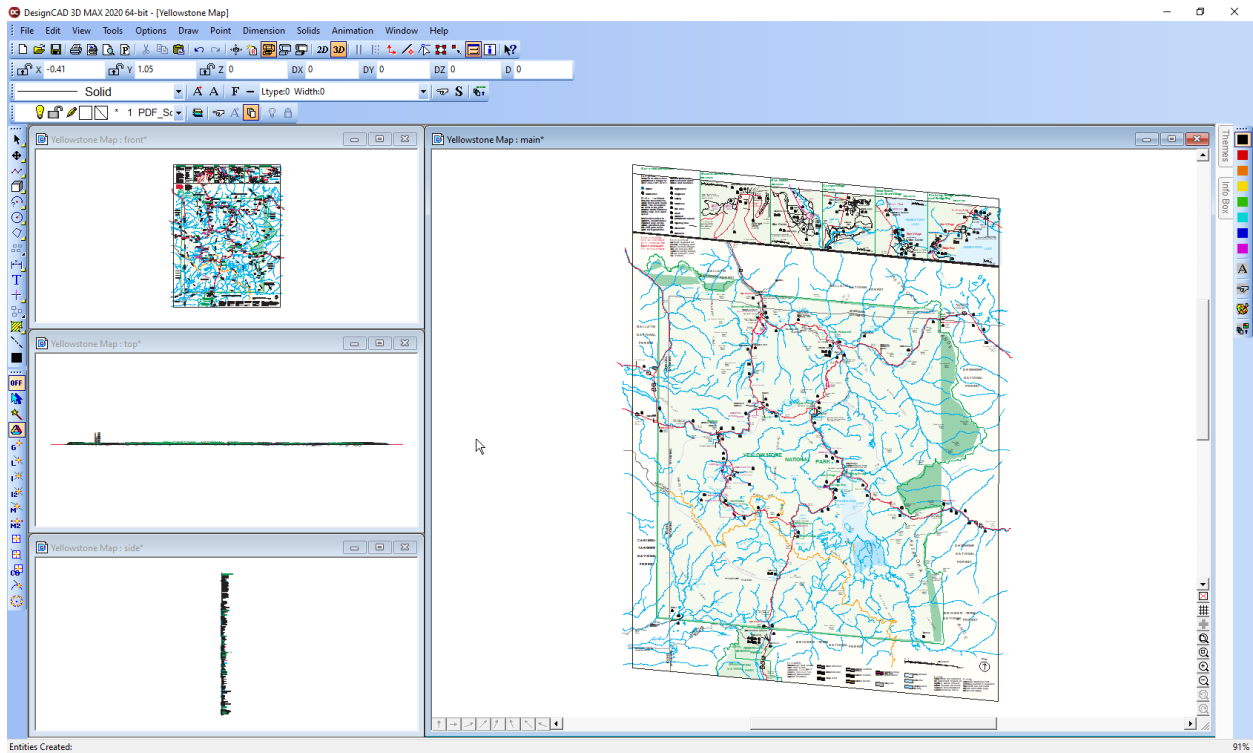

### 3. Support for SketchUp 2020

*Available in DesignCAD 3D Max and DesignCAD 2D Express.*

DesignCAD now supports SketchUp 2020. Below image shows the SketchUp 2020 file imported in DesignCAD.

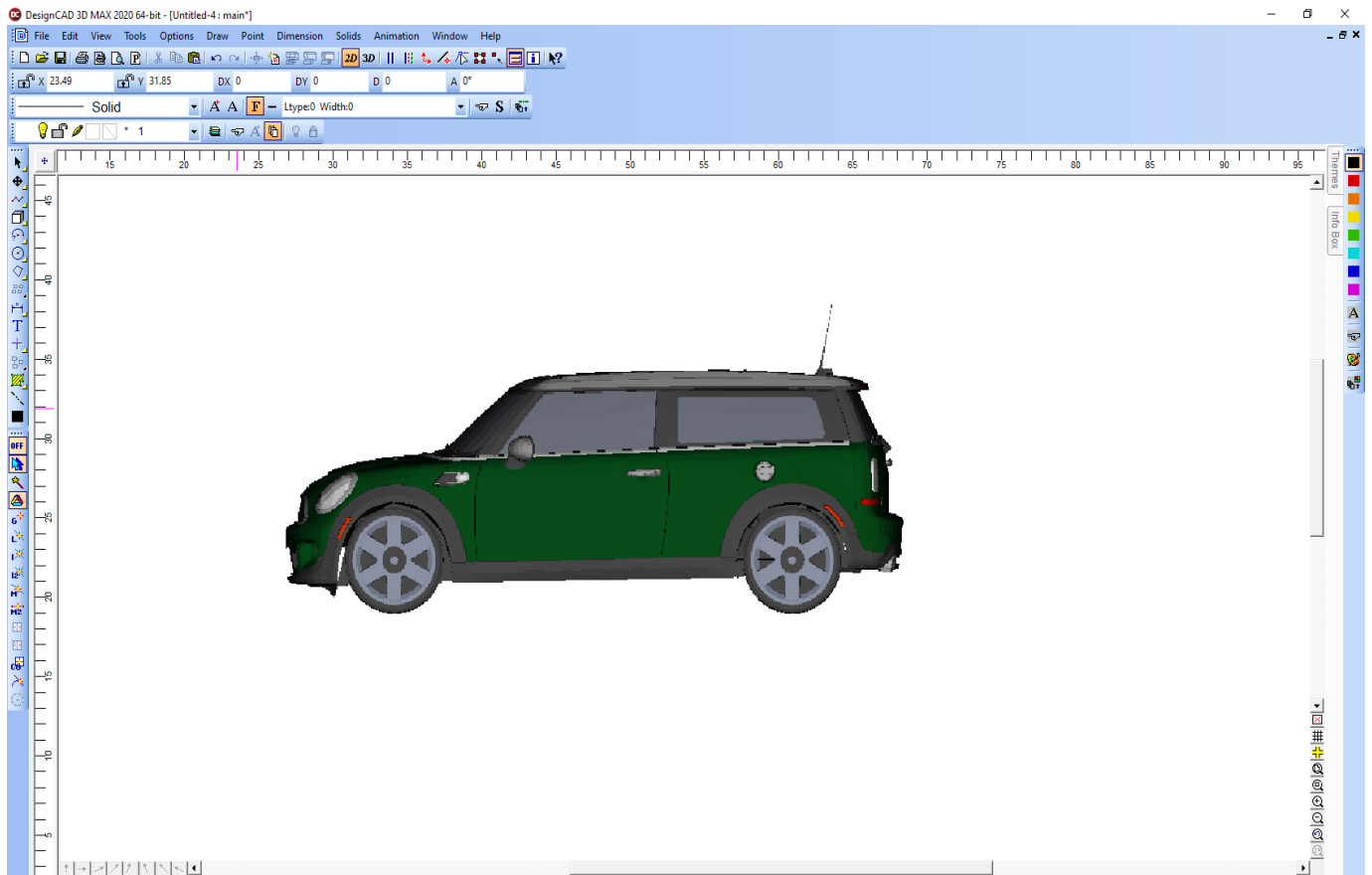

## 4. Support for AutoCAD 2020

*Available in DesignCAD 3D Max and DesignCAD 2D Express.*

DesignCAD 2020 now supports import and export of AutoCAD 2020 .DWG and .DXF file formats. Below images show AutoCAD 2020 DWG files that have been imported in DesignCAD 2020.

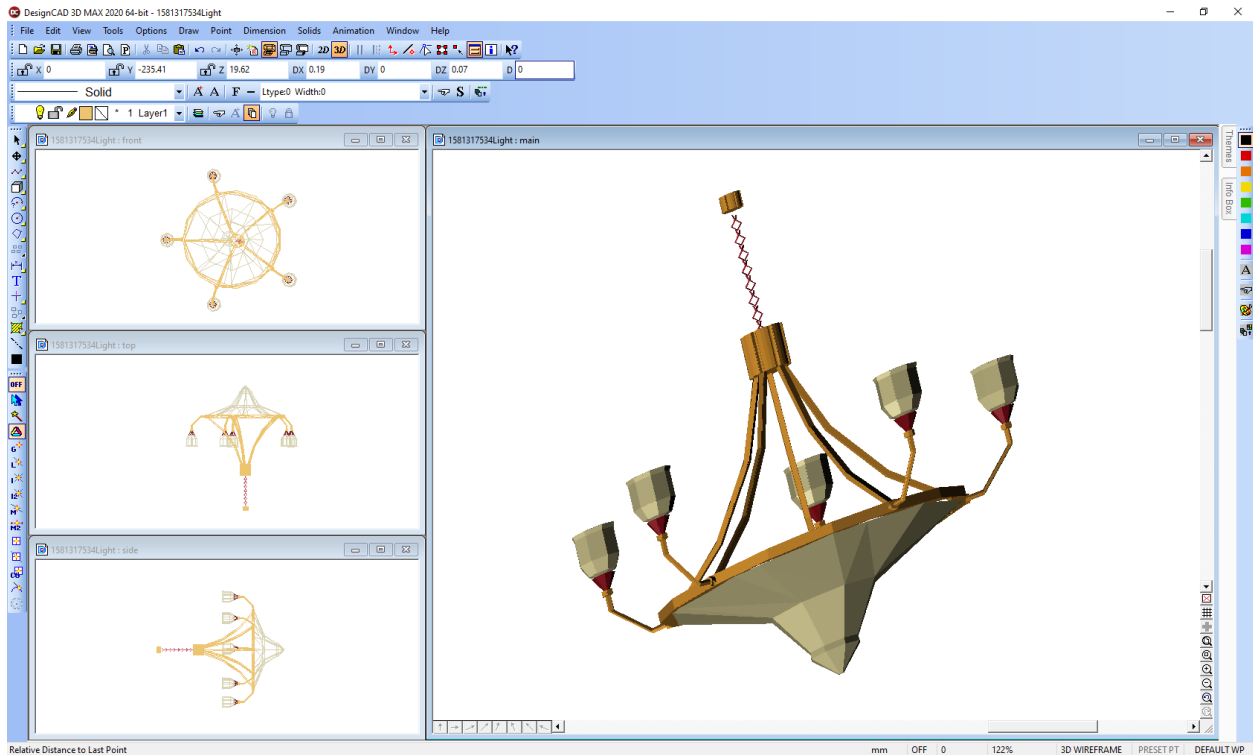

## 5. Best Fit line and best fit circle

*Available in DesignCAD 3D Max and DesignCAD 2D Express.*

The Best Fit Line and Circle tools are perfect for tracing precise curves over rough images. Both tools allow the designer to over sample a collection of points to account for fuzzy data.

### **Best Fit Line:**

Enter an arbitrary number of points to create a best fit line terminating with a double click.

### **Best Fit Circle:**

Enter an arbitrary number of points to create a best fit circle terminating with a double click.

Below image shows the use of best fit circle in an image.

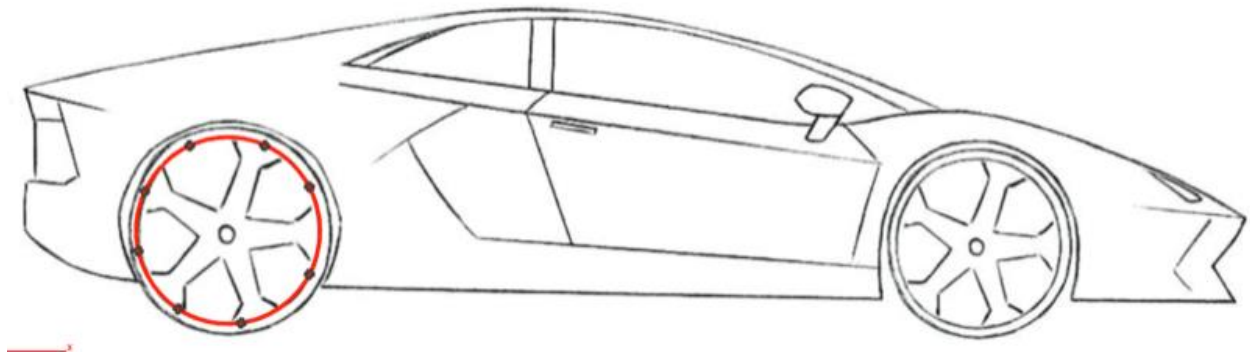

## 6. Line Distance tool enhancement

*Available in DesignCAD 3D Max only*

The minimum distance between two non-parallel lines can now be calculated through the line distance tool. Previously the distance between two parallel lines was calculated. In menu go to Dimension->info->line Distance to use this tool. Set a point on each of the two lines to measure the shortest distance.

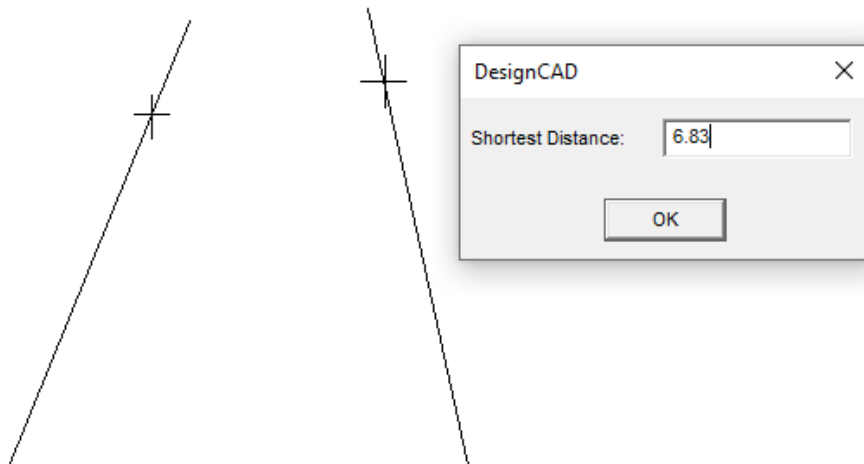

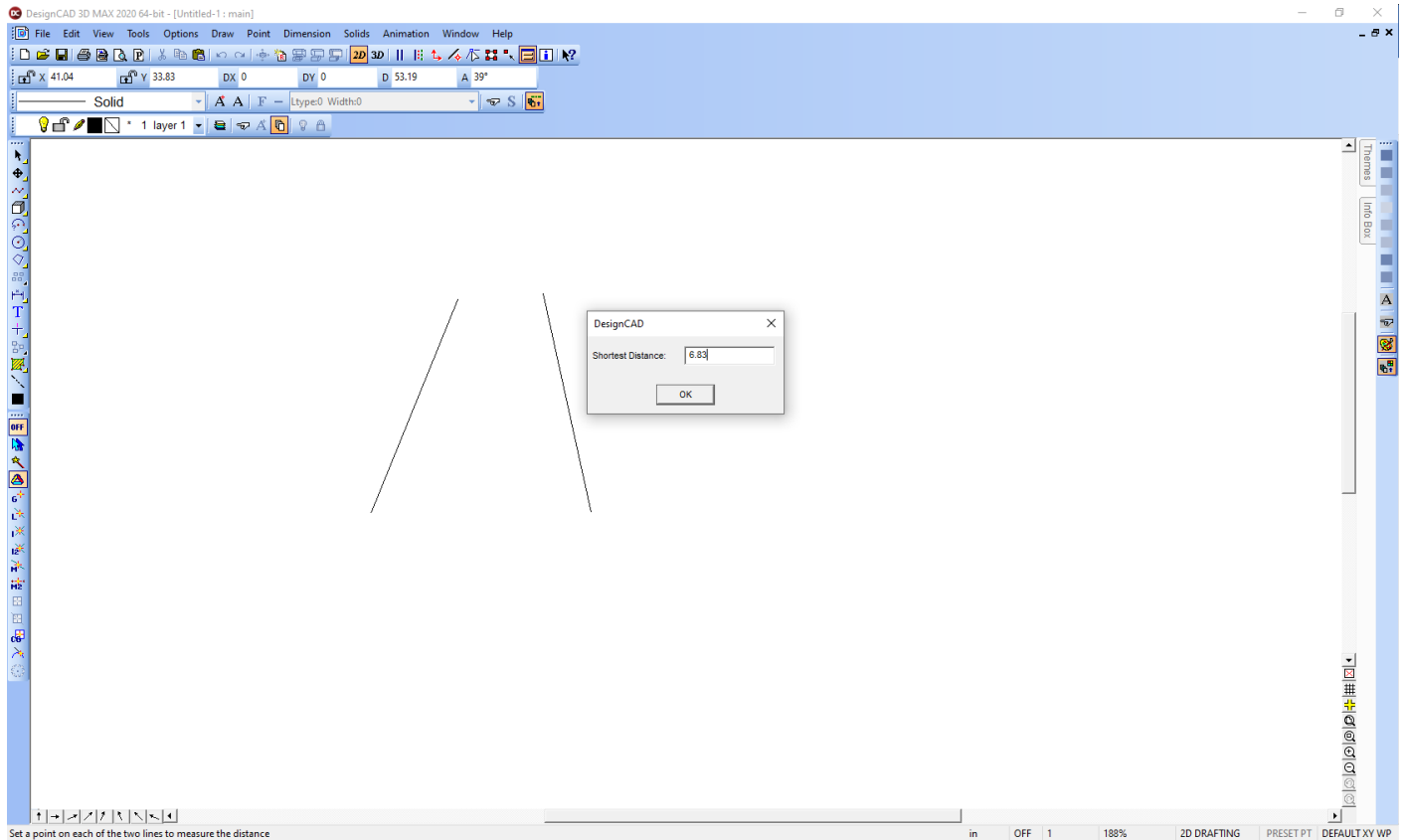

## 7. Mesh Repair Tool:

*Available in DesignCAD 3D Max Only.*

In DesignCAD 3D MAX 2020 the feature to repair mesh has also been included under the tool 3D print. User can repair the open edges and duplicate facets of a mesh. images that show how this feature can be used.

**Before Repair:**

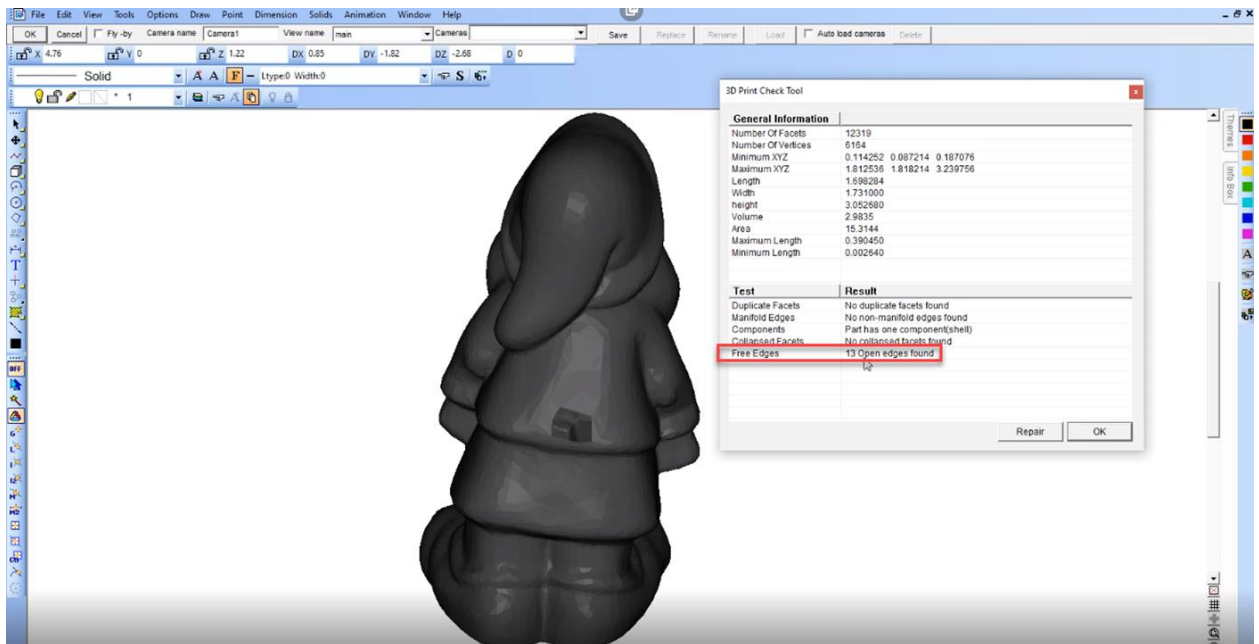
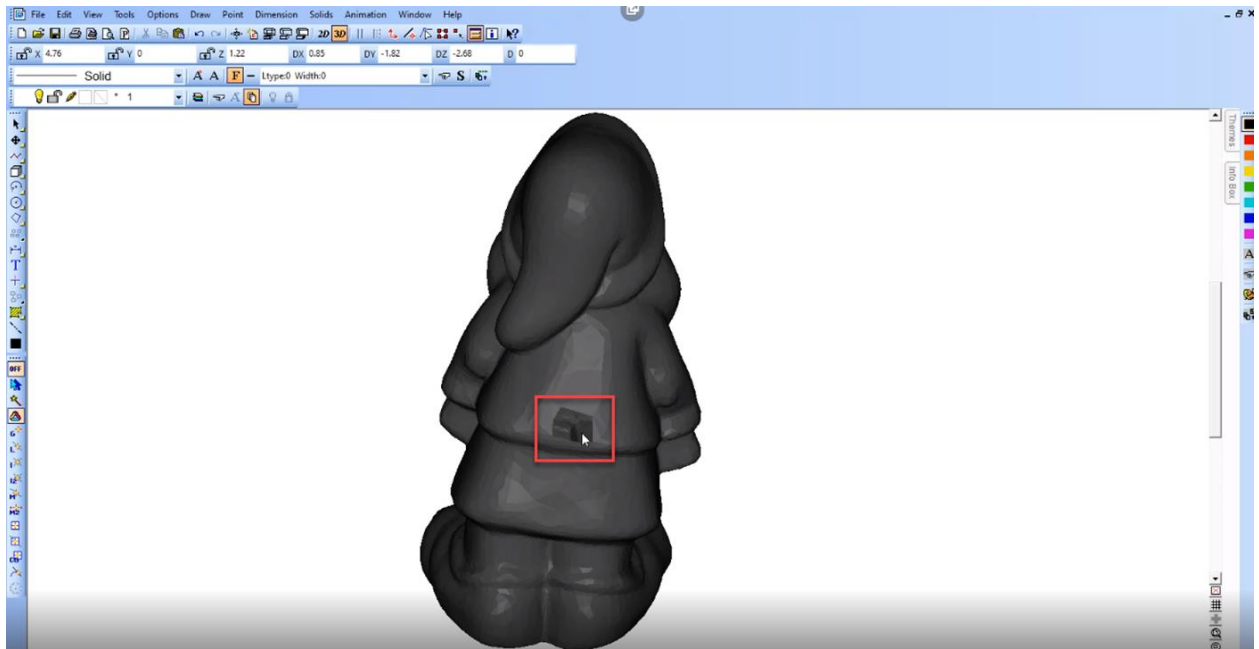

After Repair:



